

## NdFeB deep pot magnet with brass body, blue epoxy

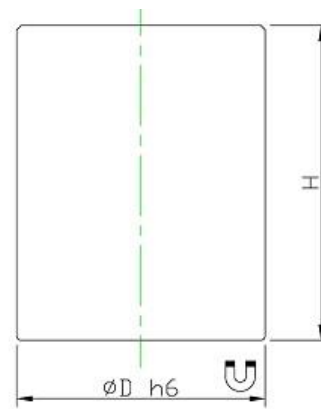
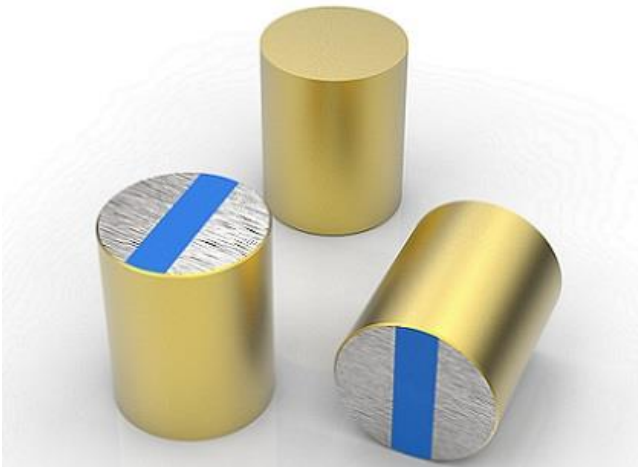

### Product description

These NdFeB deep pot magnet features high pull-force and its standard working temperature is 80 ° C.

Item No.	D	H	Force			Weight
	mm	mm	Kg	N	Lbs	g
M-RDNW6	6	20	1	10	2.2	4.5
M-RDNW8	8	20	2.5	25	5.6	8
M-RDNW10	10	20	4.5	45	10	12
M-RDNW13	13	20	7	70	15	20
M-RDNW16	16	20	15	150	33	30
M-RDNW20	20	25	28	280	63	59
M-RDNW25	25	35	46	450	101	132
M-RDNW32	32	40	71	700	157	246

