

Ferrite flat pot magnet with clinch-nut

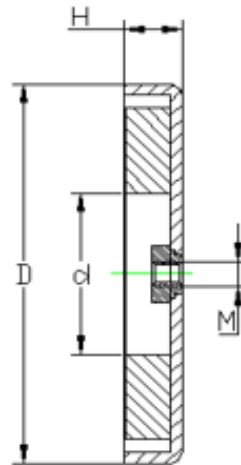

Product description

These ferrite pot magnets have a clinch-nut and can be mounted with hooks, knobs or other objects with a fitting threaded stem for holding.

They are cheap in price and the ferrite magnet does not rust easily.

Item No	D	H	d	M	Force			Weight
	mm	mm	mm		Kg	N	Lbs	g
RBFB50F-8-32	51.56	7.39	22	8-32	16	156	35	69

